

SOCIAL NARRATIVE

Independent Family Visit to
The Broad for Children on
the Autism Spectrum





We are going to The Broad.

Inside the museum, there are paintings, sculptures, and videos from all over the world.

Some of the art is from fifty years ago, and some of the art was made just last year!



**When we first arrive at The Broad, we will see a green grassy area with trees.
This is called the plaza. If I get tired or want to take a break,
the plaza is a good place to go.**

As long as I have my ticket, I can still come back into the museum.

**Just outside the museum,
we will see Visitor Services
Associates (VSAs) wearing
all black with badges
that say “Visitor Services.”
They will ask us if we
already have our tickets.**



If we already have our tickets, and it is time for us to go in, the VSA will help us get to the right place. There may be a short line, so I may need to wait for a few minutes.

A VSA will offer us a museum map so we can plan where we will go and what we will see.





If we already have our tickets, but it is not time for us to go in, we can sit on the plaza or see other sights along Grand Avenue, like Walt Disney Concert Hall.

A VSA will tell us what time we should come back to go into the museum.



If we do not have tickets, we will go to a different VSA to get them.

Sometimes there is a line to get tickets, so I may need to wait for a few minutes. A VSA will offer us a museum map so we can plan where we will go and what we will see.



**When we enter the museum,
we will see a long escalator.
We can take the escalator
or an elevator upstairs to
the third-floor galleries.**



**When we are in the galleries,
I will remember four important
safety rules:**

1. I will not touch the artwork.

**2. I will keep my hands
and feet to myself.**

3. I will stay with an adult.

**4. We will walk and
stay with our group.**



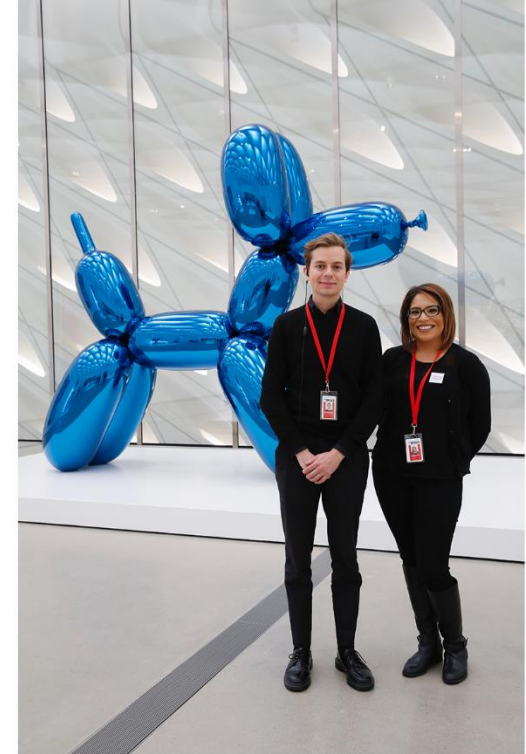

There are VSAs stationed throughout the museum. They are here to help people and keep the art safe. If I get lost and can't find my family, I can tell one of the VSAs and they will help me.

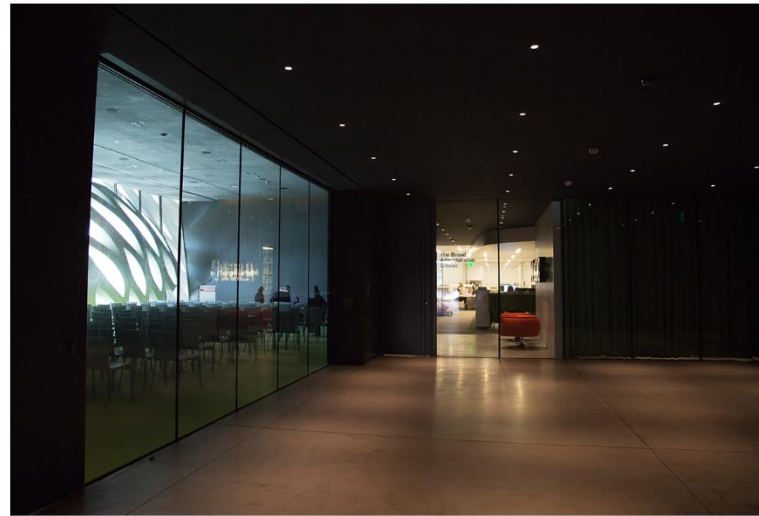

**Some areas of the museum are loud and some are quiet.
Some are crowded and some have fewer people.
My family can ask a VSA which areas
are best for me.**



If I need a break or want to leave the museum, I will tell the adult I am with.

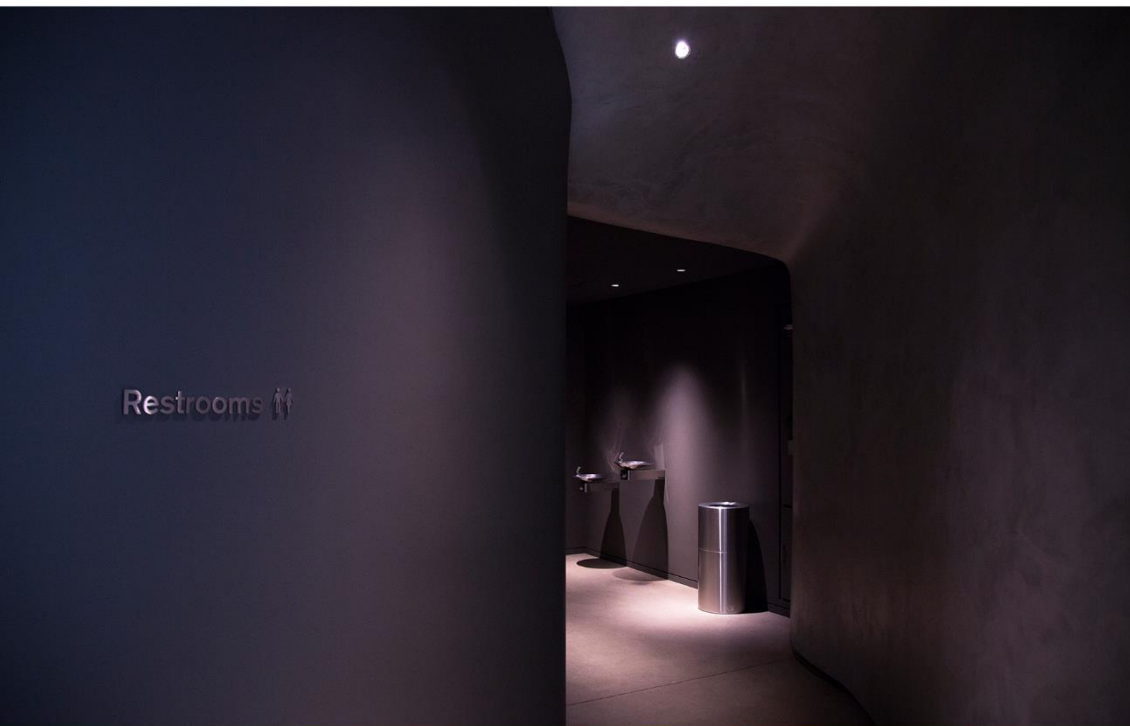

**If I need to use the restroom, I will tell the adult I am with.
My family and I can ask a VSA where the restrooms are or look on the museum map.**



**When I am ready to leave,
I will go to the lobby doors I
passed on the way in, on the
south side of Grand Avenue.**

I hope I can visit The Broad again soon to see more art.